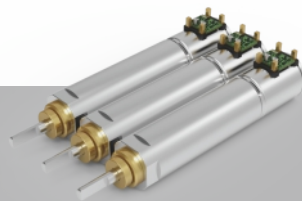

3.4
mmMetal
M
五金

ZWBMD003003

齿轮箱规格 Gearbox Specifications

外径	Outer diameter	3mm	轴承	Bearing	含油轴承 Porous bearing
材质	Material	五金 Metal	轴向窜动	Axial endplay	≤0.3mm
旋转方向	Direction of rotation	cw & ccw	输出轴径向负载	Radial loading on output shaft	≤0.3N
齿轮箱回程差	Gear backlash	≤3°	工作温度	Operating temperature range	-20 ~ +85°C

齿轮级数 Gearbox Stages

	1	2	3	4	
减速比	Reduction ratio	5	25	125	625
最大容许扭力 (gf.cm)	Max rated torque of gearbox (gf.cm)	50	50	50	50
瞬间容许力矩 (gf.cm)	Instant torque of gearbox (gf.cm)	150	150	150	150
齿轮箱效率 (%)	Gearbox efficiency (%)	85	73	65	58
长度 (mm)	Gearbox length L1 (mm)	6	7.5	9	10.5

技术插图 | Technical Drawing

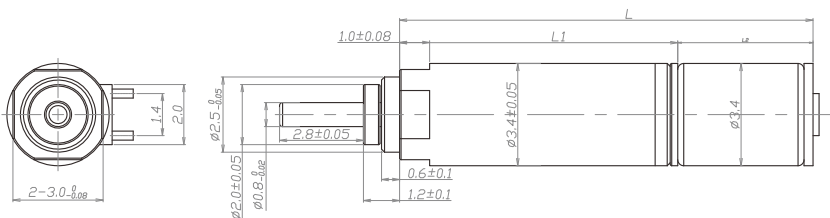

马达规格参数 Motor Specifications

马达(可选择) Motor type (optional)	步进电机 Stepper motor	输入速度 Input speed	≤10000rpm
电压(可选择) Voltage (optional)	1.5-5V	电流 Current	50mA max

型号 Model	Rated Speed 额定转速	Max Rated Torque 额定容许力矩	Max Instant Torque 瞬间容许力矩	Reduction Ratio 减速比	Gearbox Length 减速箱长 L1	Overall Length 总长 L
	rpm	gf.cm	gf.cm		mm	mm
ZWBMD003003-5	300.0	50	150	5	6.0	10.75
ZWBMD003003-25	60.0	50	150	25	7.5	12.25
ZWBMD003003-125	12.0	50	150	125	9.0	13.75
ZWBMD003003-625	2.4	50	150	625	10.5	15.25

注：可根据客户要求定制 Please contact us for customized products